



LED Spot High Performer

Features

- 1-10V dimming
- Secondary reflector, UGR < 10
- Tilt 30°
- Multiple light filter and reflector options: 10°, 15°, 20°, or 30°

Benefits

- Tune light intensity to suit your environment or the time of day
- Glare free, visually comfortable light for working, living and learning
- Light where you need it
- Enhanced control over lighting design

Application



Hotel



Retail



Shopping Mall

Specification

Order Name	Power (W)	Power Factor	Lumen (lm)	Efficacy (lm/W)	Input Current (mA)	CRI	UGR	CCT (K)	Lifetime (L70B50)
SP12WW-DIM	16	0.90	900	56	70	≥80	10	3000	20Khrs
SP16WW-DIM	20	0.90	1100	55	100	≥80	10	3000	20Khrs
SP20WW-DIM	12	0.90	500	42	60	≥80	10	3000	20Khrs
SP30WW-DIM	30	0.90	1750	58	150	≥80	10	3000	20Khrs
SP45WW-DIM	45	0.90	3400	76	230	≥80	10	3000	20Khrs

Technical Specifications

On / Off Cycles	50,000
Colour Consistency (SDCM)	6
Dimmable	Yes
Beam Angle (°)	10/15/20/30
Finishing Colour	PC+ADC12 AL
IP	IP20
Driver Integrated (Yes/No)	NO
Glow Wire Test	650°C
Driver Failure Rate	1% at 5000h
Weight (kg/pc)	0.39/0.55/0.98/1.40

Frequency (Hz)	50/60
Voltage (V)	220-240
AC/DC	AC

Mechanical Properties

Housing Material	Aluminum +Steel
Optical Material	PC

Application Conditions

Operating Temperature	-10~40°C
Application Temperature	25°C
Storage Environment	-25~50°C

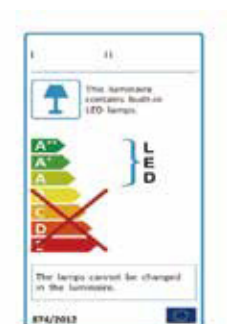

Dimensional Drawing

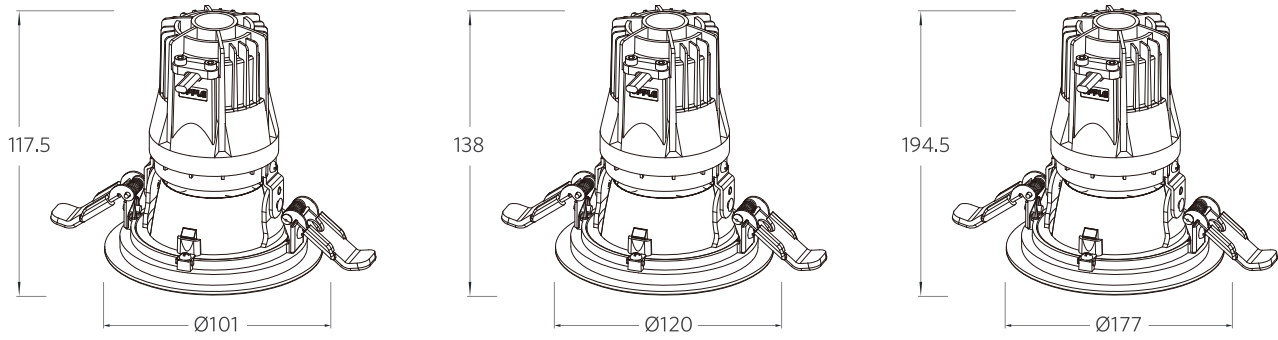

Cut-out Drawing

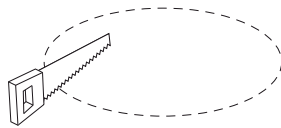

Ø112
16W/20W

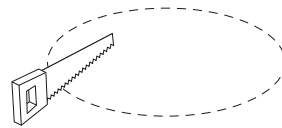

Ø160
30W/45W

Packaging Information

Order Name	Single Box(1pc/box)		Packaging Unit		
	Dimensions(mm) (LxWxH)	Gross Weight (kg)	Dimensions(mm) (LxWxH)	Gross Weight (kg)	Packing Qty (pcs/unit)
SP12WW-DIM	180x170x186	0.79	560x360x395	9.50	12
SP16WW-DIM	180x170x186	0.79	560x360x395	9.50	12
SP20WW-DIM	170x170x170	0.62	535x365x365	7.44	12
SP30WW-DIM	225x225x220	1.42	475x475x465	11.34	8
SP45WW-DIM	225x225x220	1.84	475x475x465	14.72	8

Photometric Data

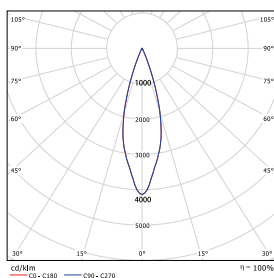

30°(12W)

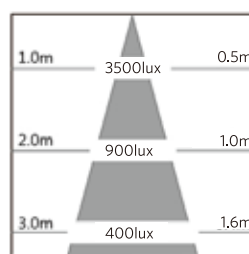

30°(16W/20W)

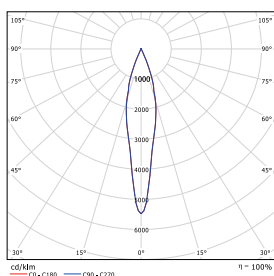
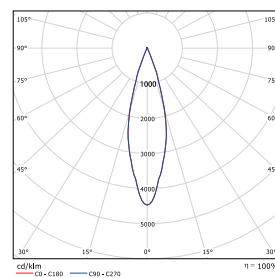

30°(30W/45W)

